

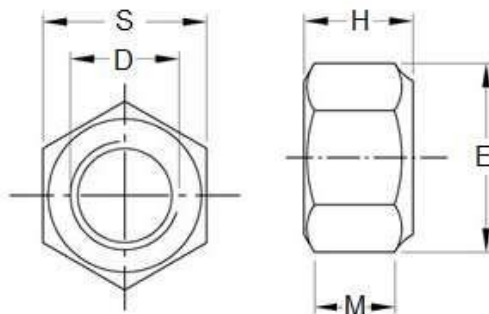

Product Dimensions, Standards and Weights

DIN 982 / ISO 7040 Technical Specifications

Metric DIN 982 Nylon Insert Hexagon Stop Lock Nuts High Type



Dimensions of Metric DIN 982 Nylon Insert Hexagon Stop Lock Nuts High Type

D	S	E	H	M	WEIGHT KG/1000pcs
M4	7	7.66	6	2.9	1.1
M5	8	8.79	6.3	4.4	1.4
M6	10	11.05	8	4.9	2.5
M8	13	14.38	9.5	6.44	5.6
M10	17	18.9	11.5	8.04	11.7
M12	19	21.1	14	10.37	16.6
M14	22	23.9	16	12.1	21
M16	24	26.76	18	14.1	34.8
M20	30	32.95	22	16.9	65
M24	36	39.55	28	20.2	127

Metric DIN 982 nylon insert lock nuts are prevailing torque type lock nuts which have a permanent undersized non metallic insert (nylon/polyamide) that produces friction between threads of mated components thereby increasing the resistance to loosening forces. DIN 982 is similar in dimensions to DIN 985 except that the total height of DIN 982 nuts is greater. Nylon insert lock nuts may be re-used a limited number of times because the threads of the mating bolt deform but do not cut into the polymer insert. These nuts are considered one-way lock nuts because they can only be installed one-way—top up. The nylon insert limits the use at elevated temperatures or when exposed to certain chemicals. Unique Fasteners offers one of the most complete ranges of metric studs and other inch and metric industrial fasteners for immediate delivery from stock. The following sizes of metric DIN 985 nylon insert lock nuts are available for immediate shipping from stock: Diameters ranging from M4 to M24 in A2 and marine grade A4 stainless steel as well as brass and steel.