

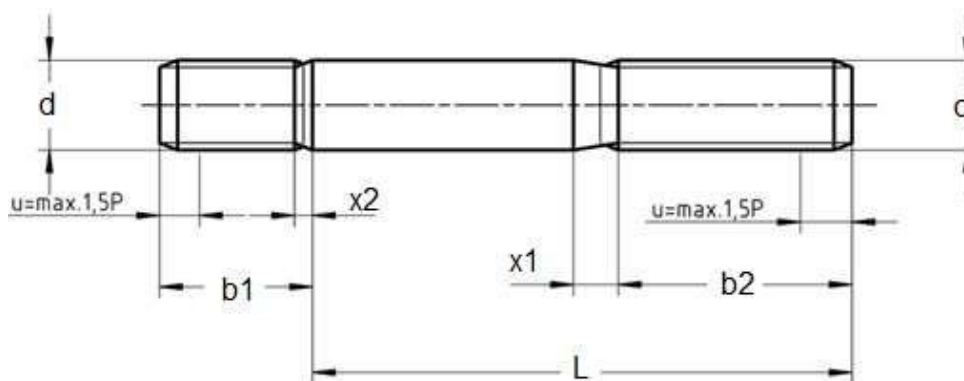

## Product Dimensions, Standards and Weights

## DIN 939 Technical Specifications

## Metric DIN 939 Double End Studs (1.25xD)



## Dimensions of Metric DIN 939 Double End Studs

DIAMETER (D)	PITCH	1.25XD (B1)	(B2) L < 125	(B2) L = 125-200	(B2) L ≥ 200	X1	X2
M8	1.25	10	22	28	—	3.2	1.6
M10	1.5	12	26	32	45	3.8	1.9
M12	1.75	15	30	36	49	4.3	2.2
M14	2	18	34	40	53	5	2.5
M16	2	20	38	44	57	5	2.5
M18	2.5	22	42	48	61	6.3	3.2
M20	2.5	25	46	52	65	6.3	3.2
M22	2.5	28	50	56	69	6.3	3.2
M24	3	30	54	60	73	7.5	3.8
M27	3	35	60	66	79	7.5	3.8
M30	3.5	38	66	72	85	9	4.5
M33	3.5	42	72	78	91	9	4.5
M36	4	45	78	84	97	10	5
M39	4	50	84	90	103	10	5
M42	4.5	52	90	96	109	11	5.5
M45	4.5	58	98	102	115	11	5.5
M48	5	60	102	108	121	13	6.3
M52	5	65	110	116	129	13	6.3



# UNIQUE FASTENERS

Precision Fasteners, Built to Last  
175/6 Sar Building, Sp Road, Bangalore, 560002



+91-8660813791



[uniquefasteners.in](http://uniquefasteners.in)



[INFO@UNIQUEFASTENERS.IN](mailto:INFO@UNIQUEFASTENERS.IN)



Metric DIN 939 double end studs are machine thread fasteners without a head and may or may not be fully threaded depending on the length of the fastener. Depending on the application, both ends can accept a nut or one end may be threaded into a pre-tapped hole, leaving the other end available for attaching a mated component secured with a nut. Studs assemblies offer several advantages over bolts: They eliminate the need for perfect squareness in an assembly allowing a nut to "float" and adjust on the nut end threads. Furthermore studs can act as pilots to ease the assembly and disassembly of mated parts.

When ordering DIN 939 double end studs, the correct dimension is diameter x nominal length (excluding the tap end  $b_1$ ). For example, with a stud measuring M10X50 (the diameter( $d$ ) = 10mm and nominal length( $l$ ) = 50 mm where the thread length on the metal end (tap end)  $b_1$  = 12 mm; the overall length of the stud is 50 + 12 = 62 mm. The thread length on the nut end  $b_2$  varies depending on the length of the stud as illustrated in the table above.

**Note: Studs whose length (L) is less than or equal to 2 times their nominal diameter + 6mm, will normally be fully threaded.**

Unique Fasteners offers one of the most complete ranges of metric studs and other inch and metric industrial fasteners for immediate delivery from stock. The following sizes of metric DIN 939 double end studs are available for immediate shipping from stock: Diameters ranging from M5 to M30 and lengths to 120mm in A2 and marine grade A4 stainless steel.