

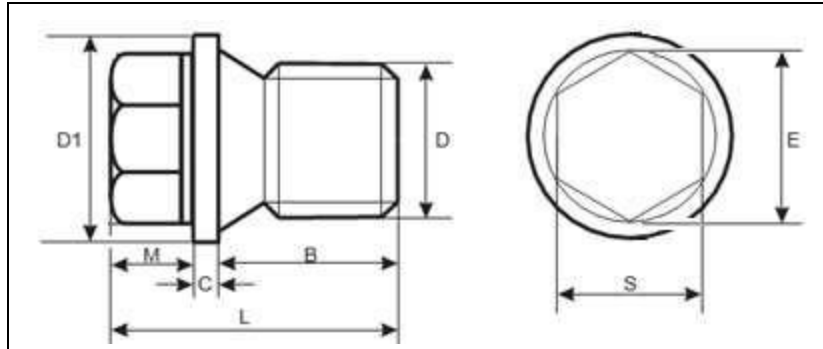

Product Dimensions and Weights

DIN 910 Technical Specifications

Metric DIN 910 Hexagon Head Screw Plug with Collar



D (NOMINAL)	D1	L	C	B	M	S	E	WEIGHT kg/1000pcs
M10-1.00	14	17	3	8	6	10	10.89	12
M12-1.50	17	21	3	12	6	13	14.2	20.3
M14-1.50	19	21	3	12	6	13	14.2	25
M16-1.50	21	21	3	12	6	17	18.72	35.2
M18-1.50	23	24	4	12	8	17	18.72	48.6
M20-1.50	25	26	4	14	8	19	20.88	64.5
M22-1.50	27	26	4	14	8	19	0.88	73.4
M24-1.50	29	27	4	14	9	22	23.91	93.5
M26-1.50	31	30	4	14	10	24	6.17	120
M30-1.50	36	30	4	16	10	24	26.17	148
M36-1.50	42	33	5	16	11	27	29.56	220
M38-1.50	44	32	5	16	11	27	29.56	238
M42-1.50	49	33	5	16	12	30	32.95	300
M45-1.50	52	33	5	16	12	30	32.95	340
M48-1.50	55	33	5	16	12	30	32.95	375

All measurements are in mm



UNIQUE FASTENERS

Precision Fasteners, Built to Last
175/6 Sar Building, Sp Road, Bangalore, 560002



+91-8660813791



uniquefasteners.in



INFO@UNIQUEFASTENERS.IN



Metric DIN 910 hexagon head screw plugs with collar/flange and cylindrical/straight/parallel thread are threaded plugs with an external hexagon head protruding from the collar end and cylindrical (parallel/straight) pipe thread along most of the length of the other end. The collar provides a larger bearing surface to seat flush in a preformed hole or on the surface of the mating substrate when fully tightened. The external hexagon drive allows significantly higher tightening torques when necessary. These plugs are typically used to seal cylindrically threaded holes in pipes and fittings carrying air, gases or fluids under pressure. Often additional sealing coating such as thread seal tape ("teflon tape"), a liquid pipe sealant applied to the threads, or preapplied sealant is necessary for a perfect seal. Metric DIN 910 hexagon head screw plugs with collar/flange and cylindrical/straight thread are available in brass, steel as well as stainless steel A2 and A4. Unique Fasteners offers one of the most complete ranges of metric pipe plugs and other inch and metric industrial fasteners for immediate delivery from stock. The following sizes of metric DIN 910 hexagon head screw plugs with collar and cylindrical thread are available for immediate shipping from stock: Diameters ranging from M10 to M48 in brass, steel and stainless steel A2 and A4.

DIN (**D**eutsches Institut für **N**ormung - German Institute for Standardization) standards are issued for a variety of components including industrial fasteners as metric DIN 910 hexagon head screw plugs with collar and cylindrical thread. The DIN standards remain common in Germany, Europe and globally even though the transition to ISO standards is taking place. DIN standards continue to be used for parts which do not have ISO equivalents or for which there is no need for standardization like DIN 910 hexagon head screw plugs with collar/flange and cylindrical/straight/parallel thread.