



## Product Dimensions and Weights

## DIN 6340 Technical Specifications

### Metric DIN 6340

### Heavy Duty Hardened Washers

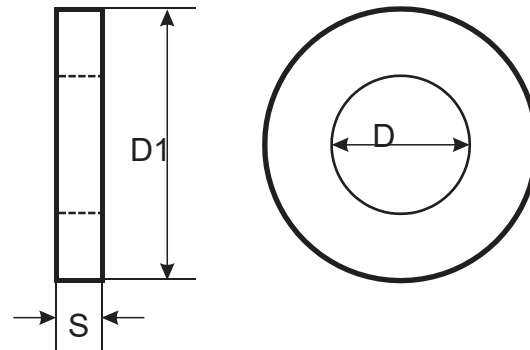

For screws with thread size	D	D1	S	Weight Kg/1000pcs
<b>M 6</b>	6.4	17	3	5
<b>M 8</b>	8.4	23	4	11
<b>M 10</b>	10.5	28	4	17
<b>M 12</b>	13	35	5	33
<b>M 14</b>	15	40	5	42
<b>M 16</b>	17	45	6	64
<b>M 18</b>	19	45	6	62
<b>M 20</b>	21	50	6	76
<b>M 22</b>	23	50	8	92
<b>M 24</b>	25	60	8	135
<b>M 27</b>	28	68	10	210
<b>M 30</b>	31	68	10	230
<b>M 36</b>	38	80	12	350
<b>M 42</b>	44	100	15	670
<b>M 48</b>	50	110	17	920



# UNIQUE FASTENERS

Precision Fasteners, Built to Last  
175/6 Sar Building, Sp Road, Bangalore, 560002



+91-8660813791



[uniquefasteners.in](http://uniquefasteners.in)



[INFO@UNIQUEFASTENERS.IN](mailto:INFO@UNIQUEFASTENERS.IN)



Metric DIN 6340 Heavy Duty Hardened Washers are circular flat washers with a central hole that are thicker and have a larger outer diameter (OD) than the most commonly used metric flat washer (DIN 125). Consequently, the DIN 6340 Heavy Duty Hardened Washers have a larger surface area and are used where larger bearing surfaces are required. DIN 6340 flat washers are mainly used for elongated holes. The following sizes of DIN 6340 Heavy Duty Hardened Washers are available for immediate shipping from stock: Diameters ranging from M6 to M30 in heat treated hardened steel - tempered, hardness (350 + 80) HV 30.

DIN (Deutsches Institut für Normung - German Institute for Standardization) standards are issued for a variety of components including industrial fasteners as Metric DIN 6340 Heavy Duty Hardened Washers. The DIN standards are commonly used in Germany, Europe and globally even though the transition to ISO standards is gradually taking place. DIN standards continue to be used for parts which do not have ISO equivalents or for which there is no need for standardization as DIN 6340 Heavy Duty Hardened Washers.