

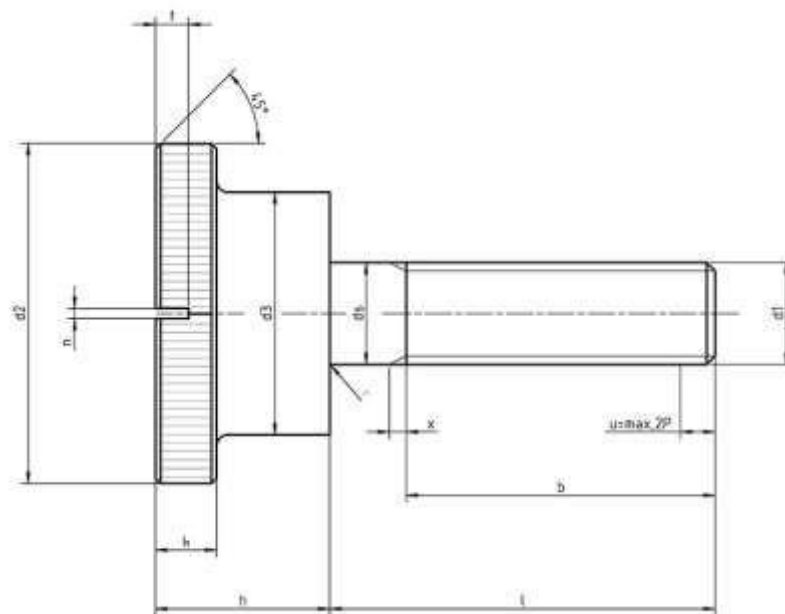

Product Dimensions and Weights

DIN 465 Specifications

Metric DIN 465 Slotted Knurled Thumb Screws



Dimensions of Metric DIN 465 Slotted Knurled Thumb Screws

| Thread d | | M1 | M1.2 | M1.4 | M1.6 | M2 | M2.5 | M3 | (M3.5) | M4 | M5 | M6 | M8 | M10 |
|----------|---------|-----------------|------|------|------|-----|------|------|--------|------|------|------|------|------|
| P | | 0.3 | 0.25 | 0.3 | 0.35 | 0.4 | 0.45 | 0.5 | 0.6 | 0.7 | 0.8 | 1 | 1.25 | 1.5 |
| b | | 3 | 3.5 | 4 | 5 | 6 | 8 | 9 | 10 | 12 | 15 | 18 | 24 | 30 |
| c | | Edges chamfered | | | | 0.3 | 0.3 | 0.4 | 0.4 | 0.4 | 0.5 | 0.6 | 0.6 | |
| dk | Nominal | 5.5 | 6 | 7 | 7.5 | 9 | 11 | 12 | 14 | 16 | 20 | 24 | 30 | 36 |
| | max. | 5.7 | 6.24 | 7.29 | 7.79 | 9.3 | 11.4 | 12.4 | 14.35 | 16.4 | 20.4 | 24.4 | 30.4 | 36.5 |
| | min. | 5.3 | 5.76 | 6.71 | 7.21 | 8.7 | 10.7 | 11.7 | 13.65 | 15.7 | 19.6 | 23.6 | 29.6 | 35.5 |



UNIQUE FASTENERS

Precision Fasteners, Built to Last
175/6 Sar Building, Sp Road, Bangalore, 560002



+91-8660813791

uniquefasteners.in

INFO@UNIQUEFASTENERS.IN



| Thread d | | M1 | M1.2 | M1.4 | M1.6 | M2 | M2.5 | M3 | (M3.5) | M4 | M5 | M6 | M8 | M10 |
|----------|----------------|-----|------|------|------|-----|------|------|--------|------|------|------|------|------|
| ds | Nominal = max. | 2.8 | 3 | 3.5 | 3.8 | 4.5 | 5 | 6 | 7 | 8 | 10 | 12 | 16 | 20 |
| | min. | 2.6 | 2.75 | 3.2 | 3.5 | 4.2 | 4.7 | 5.7 | 6.64 | 7.64 | 9.64 | 11.6 | 15.6 | 19.5 |
| h | Nominal | 3.5 | 4 | 4.7 | 5 | 5.3 | 6.5 | 7.5 | 8.5 | 9.5 | 11.5 | 15 | 18 | 23 |
| | max. | 3.7 | 4.24 | 4.94 | 5.24 | 5.5 | 6.79 | 7.79 | 8.79 | 9.79 | 11.9 | 15.4 | 18.4 | 23.4 |
| | min. | 3.3 | 3.76 | 4.46 | 4.76 | 5.1 | 6.21 | 7.21 | 8.21 | 9.21 | 11.2 | 14.7 | 17.7 | 22.6 |
| k | Nominal = max. | 1.5 | 1.5 | 2 | 2 | 2 | 2.5 | 2.5 | 3 | 3.5 | 4 | 5 | 6 | 8 |
| | min. | 1.3 | 1.25 | 1.75 | 1.75 | 1.8 | 2.25 | 2.25 | 2.75 | 3.2 | 3.7 | 4.7 | 5.7 | 7.64 |
| n | Nominal | 0.3 | 0.4 | 0.4 | 0.4 | 0.5 | 0.6 | 0.8 | 0.8 | 1 | 1.2 | 1.6 | 2 | 2.5 |
| | min. | 0.4 | 0.46 | 0.46 | 0.46 | 0.6 | 0.66 | 0.86 | 0.86 | 1.06 | 1.26 | 1.66 | 2.06 | 2.56 |
| | max. | 0.5 | 0.6 | 0.6 | 0.6 | 0.7 | 0.8 | 1 | 1 | 1.2 | 1.51 | 1.91 | 2.31 | 2.81 |
| r | | 0.5 | 0.5 | 0.5 | 0.5 | 0.5 | 0.5 | 0.5 | 0.5 | 0.5 | 1 | 1 | 2 | 2 |
| t | min. | 0.7 | 0.8 | 0.9 | 1 | 1.1 | 1.5 | 1.8 | 2 | 2.2 | 2.8 | 3.5 | 4.5 | 6 |
| | max. | 0.9 | 1 | 1.15 | 1.3 | 1.4 | 1.8 | 2.2 | 2.5 | | | | | |

All measurements are in mm

Metric DIN 465 are raised knurled head thumb screws with a slotted drive. These screws have a wide shallow cylindrical head with ridged (knurled) sides with an unthreaded shoulder immediately below the bearing surface. Metric thumb screws are designed for quick and convenient tightening and loosening by hand without the need of any tool or driver. However metric DIN 465 also have a slotted drive allowing the screw to be turned with a slot screw driver. The large head with the knurled grip allows the screw to be tightened or loosened with minimal external force. This feature makes the screw an ideal fastener for any device that require frequent assembly/disassembly. They are commonly used to fasten safety covers of electronic devices. They are typically inserted and tightened into pre-drilled tapped hole. Metric DIN 465 Slotted Knurled Thumb Screws are available in styles: full thread (type A), part thread (type B) and a slotted head (type Sz). These screws are available in steel as well as stainless steel A2 and A4. Unique Fasteners offers over 500.000 unique fastener products from stock in inch and metric standard in a variety of materials and finishes. The following sizes of metric DIN 465 slotted knurled head thumb screws are available for immediate shipping from stock: Diameters ranging from M3 to M6 up to 20mm long in 303 stainless steel.

DIN (Deutsches Institut für Normung - German Institute for Standardization) standards are issued for a variety of components including industrial fasteners as metric DIN 465 Slotted Knurled Thumb Screws. The DIN standards remain common in Germany. Europe and globally even though the transition to ISO standards is taking place. DIN standards continue to be used for parts which do not have ISO equivalents or for which there is no need for standardization like DIN 465 Slotted Knurled Thumb Screws.